



Serie/Series

1800

**RACCORDI E ACCESSORI
CON ATTACCO A BAIONETTA**
*FIXTURES AND FITTINGS
WITH BAYONET CONNECTION*

Caratteristiche Tecniche | Technical Characteristics

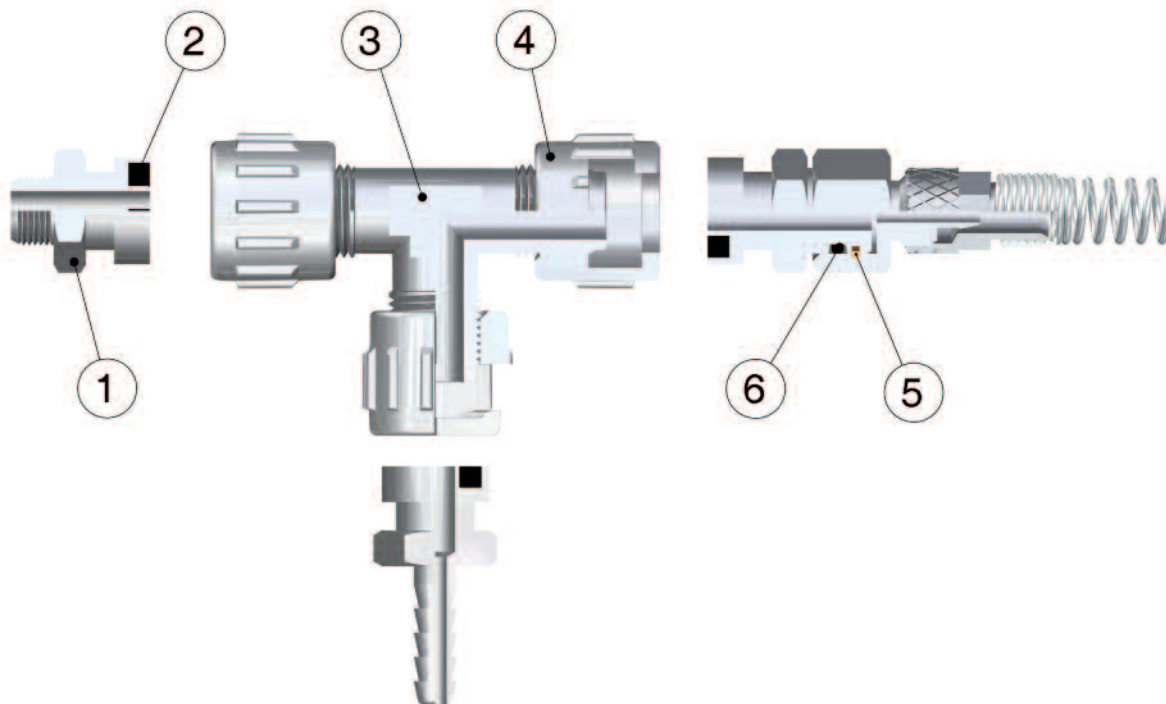

Materiali e Componenti | Component Parts and Materials

- 1 Baionetta in Ottone Nichelato
- 2 Guarnizione in NBR 90
- 3 Corpo in ottone nichelato
- 4 Dado capettato in zama nichelato
- 5 Seeger in bronzo
- 6 Guarnizione o-ring in NBR 70

- 1 Nickel-plated brass Bayonet
- 2 NBR 90 Seals
- 3 Nickel-plated brass Body
- 4 Nickel-plated zamac Milled Nut
- 5 Bronze Seeger
- 6 NBR 70 o-ring seal

Pressioni | Pressures

Pressioni e temperature sono determinate dal tipo di tubo impiegato, pertanto tali valori sono da definirsi in base alle caratteristiche del tubo stesso. I valori riguardano quindi esclusivamente i componenti da noi prodotti.

The working pressure and working temperatures depend on which type of tube is used, for this reason, the values must be determined in accordance with the tube's features.

Pressione minima / Minimum pressure: **-0.99 bar (-0.099 MPa)**

Pressione massima / Maximum pressure: **15 bar (1.5 MPa)**

Filettature | Threads

Gas cilindrica conforme ISO 228 Classe A / Parallel gas in conformity with ISO 228 Class A.

Metrica conforme ISO R/262 / Metric in conformity with ISO R/262.

Tubi di collegamento | Connection Tubes

Tubi in materiale plastico:

PA6, PA11, PA12, Polietilene, *Poliuretano, PVC intrecciato.

Poliuretano intrecciato per l'articolo 1810

*Per tubi in Poliuretano é consigliata una durezza di 98 shore.

Plastic tubes:

PA6, PA11, PA12, Polyethylene, *Polyurethane, Braided PVC.

Braided polyurethane for Art. 1820

*For Polyurethane hoses it is required a minimum hardness of 98 shore.

Temperature | Temperatures

Temperatura minima / Minimum temperature: **-18 °C**

Temperatura massima / Maximum temperature: **+70 °C**

Fluidi compatibili | Fluids

Aria compressa, fluidi e liquidi a bassa pressione compatibili con il tipo di accoppiamento.

Compressed air, fluids and liquids at low pressure compatible with the connection.

COME ORDINARE

I raccordi e accessori standard con attacco a baionetta prevedono:

- Trattamento superficiale di NICHELATURA

Per formulare un ordine é sufficiente specificare ARTICOLO, MISURA, QUANTITA'.

HOW TO ORDER

The standard fixtures and fittings with bayonet connection are supplied with:

- Surface treatment of NICKEL-PLATING

To order simply specify the ARTICLE CODE, SIZE and QUANTITY.

1830

RACCORDO MASCHIO A BAIONETTA - MALE BAYONET

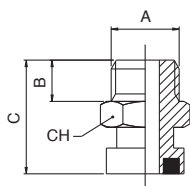

A	B	C	CH	Conf. Pack.
1/8	6	19.5	15	25
1/4	8	22	15	25
3/8	9	23	19	25

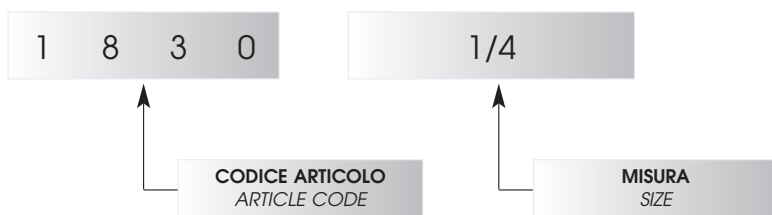

1810

RACCORDI PER TUBI IN GOMMA - FITTING FOR RUBBER HOSE

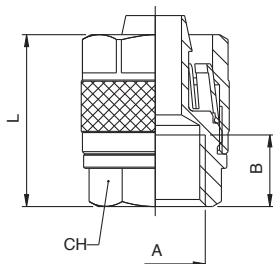
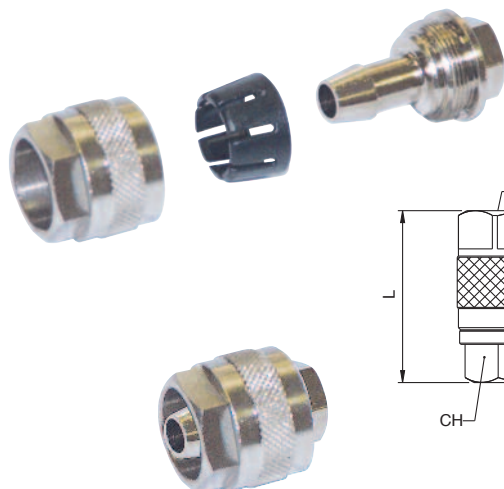

Tubo/Tube	A	B	L	CH	Conf. Pack.
14/6	1/4	11	30	16	25
17/8	1/4	11	31	16	25
19/10	1/4	11	31	17	25
23/13	1/2	17	36	24	25

RACCORDI PER TUBI IN POLIURETANO INTRECCIATO
FITTINGS FOR BRAIDED POLYURETHANE HOSES

Tubo/Tube	A	B	L	CH	Conf. Pack.
10/6	1/4	11	30	15	25
12/8	1/4	11	31	16	25
15/10	1/4	11	31	17	25



1830

RACCORDO MASCHIO A BAIONETTA - MALE BAYONET

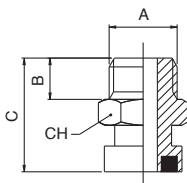
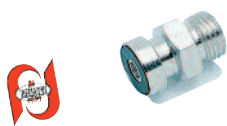

A	B	C	CH	Conf. Pack.
1/8	6	19,5	15	25
1/4	8	22	15	25
3/8	9	23	19	25

1831

RACCORDO FEMMINA A BAIONETTA - FEMALE BAYONET

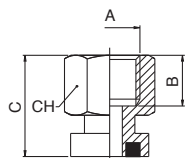

A	B	C	CH	Conf. Pack.
1/8	8,5	19,5	15	25
1/4	11	22	17	25
3/8	11	22	20	25

1832

RACCORDO BAIONETTA A RESCA - BAYONET WITH REST

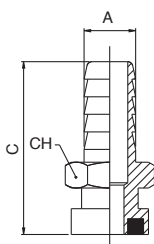

Tubo/Tube	A	C	CH	Conf. Pack.
int. 6	6	33,5	15	25
int. 7	7	33,5	15	25
int. 8	8	33,5	15	25
int. 9	9	33,5	15	25
int. 10	10	33,5	15	25
int. 12	12	33,5	15	25

1833

RACCORDO BAIONETTA PORTAGOMMA - BAYONET FOR RUBBER HOSE

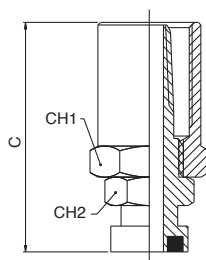

Tubo/Tube	CH1	CH2	C	Conf. Pack.
est. 14 - int. 6	17	15	44,5	25
est. 17 - int. 8	20	15	44,5	25
est. 19 - int. 10	22	15	44,5	25

1840

RACCORDO MASCHIO PORTAGOMMA - MALE FOR RUBBER HOSE

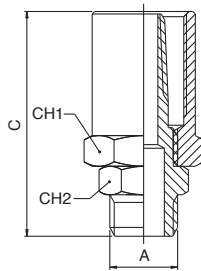
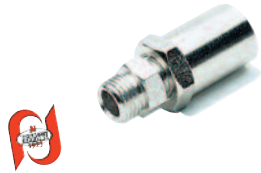

Tubo/Tube	A	CH1	CH2	C	Conf. Pack.
10/6 - 1/4	15	17	43	25	
12/8 - 1/4	15	17	43	25	
14/6 - 1/4	17	17	43	25	
15/10 - 1/4	18	17	43	25	
17/8 - 1/4	20	17	43	25	
17/8 - 3/8	20	19	44	25	
19/10 - 1/4	22	17	43	25	
19/10 - 3/8	22	19	44	25	

1841

RACCORDO FEMMINA PORTAGOMMA - FEMALE FOR RUBBER HOSE

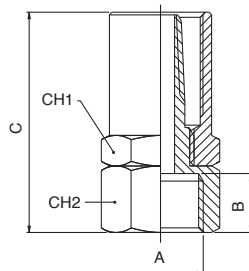

Tubo/Tube	A	B	C	CH1	CH2	Conf. Pack.
10/6 - 1/4	11	43	15	17	25	
12/8 - 1/4	11	43	15	17	25	
14/6 - 1/4	11	43	17	17	25	
15/10 - 1/4	11	43	18	17	25	
17/8 - 1/4	11	43	20	17	25	
17/8 - 3/8	11.5	43.5	20	20	25	
19/10 - 1/4	11	43	22	17	25	
19/10 - 3/8	11.5	43.5	22	20	25	

1855

RACCORDO DIRITTO CON ATTACCO A BAIONETTA + DADO CON MOLLA
STRAIGHT FITTING WITH BAYONET CONNECTION + NUT AND SPRING

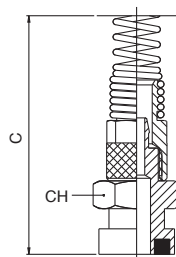

Tubo/Tube	CH	C	Conf. Pack.
6/4	15	110	25
8/6	15	115	25
10/8	15	123	25
12/10	16	130	25

1860

RACCORDO DIRITTO GIREVOLE CON ATTACCO A BAIONETTA + DADO CON MOLLA
SWIVEL STRAIGHT FITTING WITH BAYONET CONNECTION + NUT AND SPRING

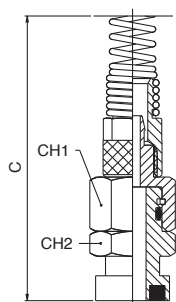
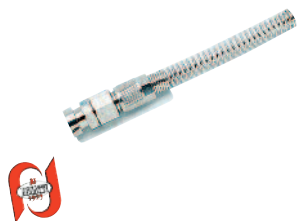

Tubo/Tube	CH1	CH2	C	Conf. Pack.
6/4	15	15	120	25
8/6	15	15	125	25
10/8	15	15	134	25
12/10	17	17	141	25

1850

RACCORDO MASCHIO CON DADO CAPETTATO - MALE WITH MILLED NUT

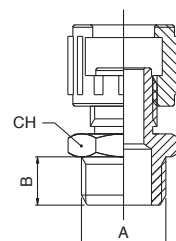

A	B	CH	Conf. Pack.
1/8	6	14	25
1/4	8	15	25
3/8	9	19	25



1851

RACCORDO FEMMINA CON DADO CAPETTATO - FEMALE WITH MILLED NUT

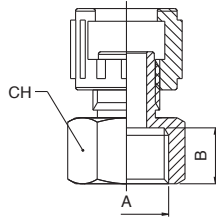
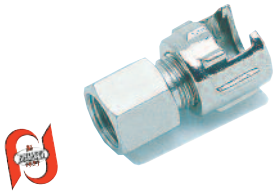

A	B	CH	Conf. Pack.
1/4	11	17	25
3/8	11	20	25

1852

RACCORDO DOPPIO DADO CAPETTATO - DOUBLE MILLED NUT

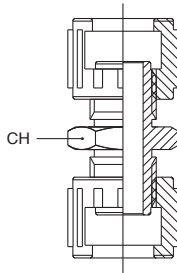

A	CH	Conf. Pack.
	15	25

1853

RACCORDO T CON DADI CAPETTATI - TEE WITH MILLED NUTS

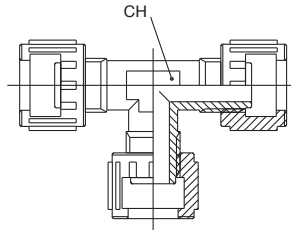

A	CH	Conf. Pack.
	13	25

1808

DADO CAPETTATO - MILLED NUT

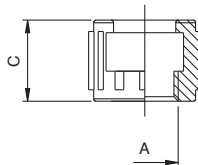

A	C	Conf. Pack.
1/4	16	25

1864

GUARNIZIONE DI TENUTA PER RACCORDI CON ATTACCO A BAIONETTA - TIGHTENING SEAL FOR FITTINGS WITH BAYONET CONNECTION

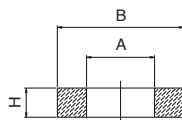

A	B	H	Conf. Pack.
7	13	3	50